



Cart 中文

Home About Us News Products Certificate Services Contact

MIN ING

Professional manufacturer for High & Low Voltage Fuses and Fusegears Combined Electrical Appliance

Product Center

>> Home / Product Center / Automotive fuses



Parameter Feature Outline Curve

Table 16

Cat. No.	Models	Name	Rated voltage (V)	Rated current (A)	Dimensions/sizes (mm)				Weight (g)
					Fig.	A	B	C D	
1601	RQ1	Fuse links	DC48/AC125	60~800	16.1	9	0.6~1.8	11	
1602	CNL	Fuse links	DC48/AC125	35,40,50,60,80,100,125	16.1	10.2	0.3~1.1	8	11
1603				130,150,175,200,225,250					
1604				275,300,325,	16.1	10.2	0.5~1.0	8	11
1605				350,400,500					
1606				600,675,750,800	16.1	12	0.65~0.9	8	11
1607									



浙江正泰电器 中国驰名商标



INQUIRY
400-800-9662

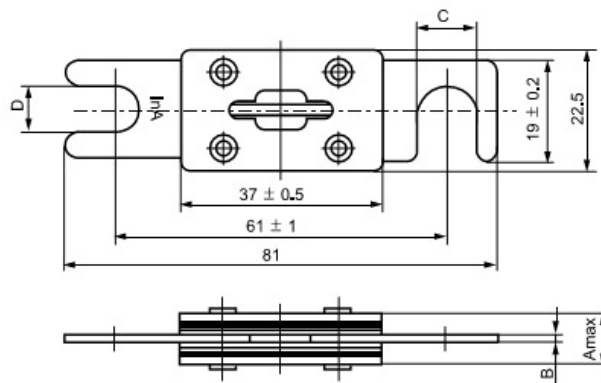

Figure 16.1

About Mingrong

- Company Profile
- Development
- Organization
- President address

News and media

- Company news
- Enterprise video
- Exhibition information

Products and Services

- Fuse links
- Bole connected fuse links
- Fuse bases
- Fuse alarms
- Fuse carriers
- Combinating electric of fuse
- Automobile Fuse
- High voltage fuse

Support

- Customer Service Center
- Customer complaints
- Marketing network
- Technical FAQ
- Download

Jobs

- Talent concept
- Recruitment information
- Recruitment line

Contact Us

- Regions
- Contact
- Sitemap



