



Cart 中文

Home About Us News Products Certificate Services Contact

MINGRONG

Professional Manufacturer for High & Low Voltage Fuses and Fusegears Combined Electrical Appliance

Product Center

>> Home / Product Center / Tube bolts



Parameter

Feature

Outline

Curve



INQUIRY
400-800-9662

Table 6

Cat. No.	Models	Rated voltage (V)	Rated current (A)	Dimensions/sizes (mm)								Weight (g)
				Fig.	A	B	C	ϕ D	E	F	ϕ d	
0601	RS94A	250	40~200	6.1	70	52	32	28	22	5	8.2 × 12	98
0602	RS94C	250	40~200	6.1	80	62	42	28	22	5	8.2 × 12	106
0603	RS94D	250	30~200	6.1	80	57	26	29	22	5	8.2 × 12	120
0604	RS94E	250	30~200	6.1	80	60	41	31	24	5	8.2 × 12	142
0605	RS94F	250	40~200	6.1	80	58	38	33	25	5	8.2 × 12	135
0606	RS94G	250	40~250	6.1	88	62	42	36	26	5	10.2 × 15	202.5
0607	RS94H	250	30~150	6.1	70	53	27	22	16	5	8.2 × 12	82
0608	RS94J	250	40~160	6.1	67	51	26	26	19	3.5	8.2 × 12	102
0609	RS95A	500/660	50~200	6.1	91	72	54	28	22	5	8.2 × 12	112.5
0610	RS95B	500/660	50~200	6.1	92	73	54	31	25	5	8.2 × 12	150
0611	RS95C	500/660	50~100	6.1	92	73	54	26	19	5	8.2 × 12	114
0612	RS95D	500	100~200	6.1	92	72	45	30	25	5	8.2 × 12	149
0613	RS95E	500/660	40~200	6.1	92	72	54	31	25	6	8.2 × 12	155
0614	RS95F	500/660	50~160	6.1	93	75	54	26	19	5	8.2 × 12	145
0615	RS95FS	500	100	6.1	100	82	48	26	19	3	8.2 × 12	124
0616	RS95G	500/660	50~200	6.1	93	75	53	31	25	5	8.2 × 10	128
0617	RS95H	250	200~250	6.1	96	70	42	36	26	5	10.2 × 15	193
0618	RS95K	250	250~400	6.1	98	70	38	47	32	5	10.2 × 15	320
0619	RS95L	700	100~200	6.1	127	108	89	31	25	5	8.2 × 12	195
0620	RS95M	500	50~200	6.1	110	81	50	31	25	5	8.2 × 10	165
0621	RS95N	700	50~160	6.1	128	101	75	25	20	6	10.5 × 15	172
0622	RS95P	250	250~315	6.1	98	68	41	38	25	6	10.5 × 18	218
0623	RS95Q	500	50~160	6.1	110	95	75	25	18	5	6.2 × 10	148
0624	RS95R	700	35~100	6.1	110	84	50	31	25	6	8.2 × 18	160
0625	RS95S	250	160~250	6.1	100	65	30	36	30	6	10.5 × 15	188
0626	RS95T	500/660	100~200	6.1	112	87	52	27	21	5	10 × 18	210
0627	RS95U	500	100	6.1	100	82	48	26	19	5	8.2 × 12	124
0628	RS95V	600	100~160	6.1	128	98	60	25	19	3	10.2 × 18	210
0629	RS95W	500	40~200	6.1	129	96	53	34	24	6	12 × 18	210
0630	RS96A	250	200~300	6.1	100	70	40	40	26	6	10.5 × 15	166
0631	RS96B	500/660	200~315	6.1	110	83	53	38	26	6	10.5 × 15	166
0632	RS96C	500/660	100~160	6.1	112	92	72	25	20	6	10.5 × 15	166
0633	RS96D	500/660	75~200	6.1	112	90	60	36	26	5	10.5 × 15	166
0634	RS96E	500/660	200	6.1	112	93	73	31	25	5	7 × 9.5	166
0635	RS96F	500/660	200~400	6.1	113	87	70	40	26	6	10.5 × 15	255
0636	RS96G	500/660	400~500	6.1	114	87	56	51	38	6	10.5 × 15	437
0637	RS96GK	250	400~500	6.1	97	67	38	51	36	8	11 × 17	198
0638	RS96H	500/660	200	6.1	117	92	67	28	22	3	7 × 9.5	132
0639	RS96K	500/660	200~400	6.1	117	80	52	40	32	6	10.5 × 15	280
0640	RS96L	500/660	200~315	6.1	117	89	57	37	30	6	10.5 × 15	280
0641	RS96M	500	50~200	6.1	135	113	67	34	20	5	8.2 × 12	196
0642	RS96N	500	250~315	6.1	115	87	58	39	26	6	10.5 × 18	245
0643	RS96P	700	125~200	6.1	130	90	50	38	25	6.3	10.5 × 26	250
0644	RS96Q	250	315~400	6.1	100	71	38	43	35	9	10.5 × 15	195
0645	RS96R	500/660	35~300	6.1	113	83	53	40	30	6.5	12.2 × 18	197
0646	RS96S	250	40~200	6.1	95	68	40	27	20	5	9 × 18	153
0647	RS97A	500/660	300~500	6.1	120	90	58	46	32	6	10.5 × 18	450
0648	RS97B	500/660	50~200	6.1	126	100	74	38	26	6	10.5 × 18	295
0649	RS97C	500/700	350~500	6.1	128	98	70	51	38	6	10.5 × 18	460
0650	RS97D	500/700	200~315	6.1	130	98	72	38	26	6	10.5 × 18	288
0651	RS97E	500/660	200~315	6.1	145	111	77	38	29	5	7 × 11	300
0652	RS97F	500/660	200~400	6.1	145	105	76	41	28	8	10.5 × 18	355
0653	RS97G	500/660	200~400	6.1	146	110	76	41	29	5	7 × 9.5	341
0654	RS97H	500/660	200~400	6.1	146	110	75	48	36	8	12.5 × 18	520
0655	RS97K	500/660	200~400	6.1	130	100	70	53	42	8	14.2 × 18	480
0656	RS97L	500	200~400	6.1	125	103	48	51	38	6	10.5 × 18	420
0657	RS97M	500	400~500	6.1	145	102	53	51	38	6.3	14.5 × 30	465
0658	RS97N	500/660	200~315	6.1	145	113	88	38	25	6.3	10.5 × 18	353

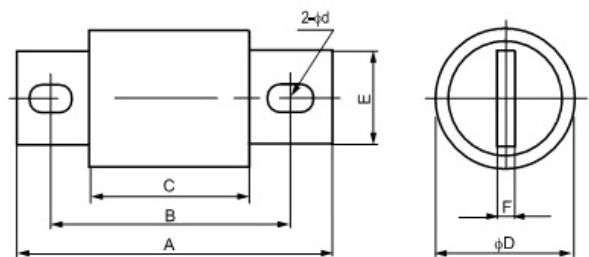

Figure 6.1

About Mingrong

- [Company Profile](#)
- [Development](#)
- [Organization](#)
- [President address](#)

News and media

- [Company news](#)
- [Enterprise video](#)
- [Exhibition information](#)

Products and Services

- [Fuse links](#)
- [Bole connected fuse links](#)
- [Fuse bases](#)
- [Fuse alarms](#)
- [Fuse carriers](#)
- [Combinating electric of fuse](#)
- [Automobile Fuse](#)
- [High voltage fuse](#)

Support

- [Customer Service Center](#)
- [Customer complaints](#)
- [Marketing network](#)
- [Technical FAQ](#)
- [Download](#)

Jobs

- [Talent concept](#)
- [Recruitment information](#)
- [Recruitment line](#)

Contact Us

- [Regions](#)
- [Contact](#)
- [Sitemap](#)

